

# KAC-6401

## SERVICE MANUAL

© 2002-11 PRINTED IN JAPAN  
B53-0007-00 (N) 3379

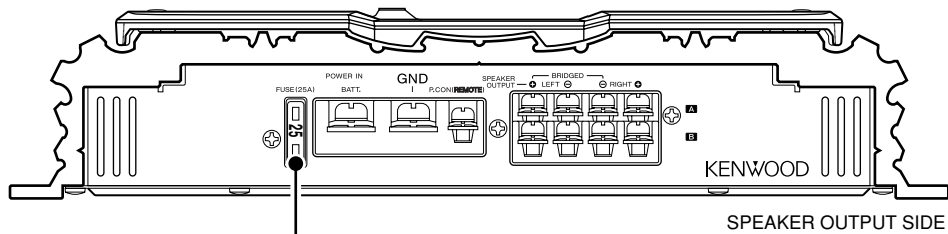
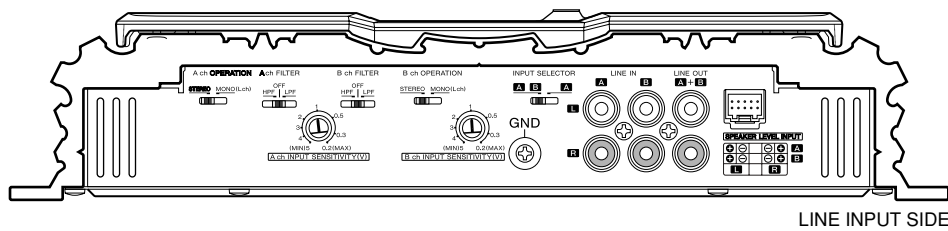
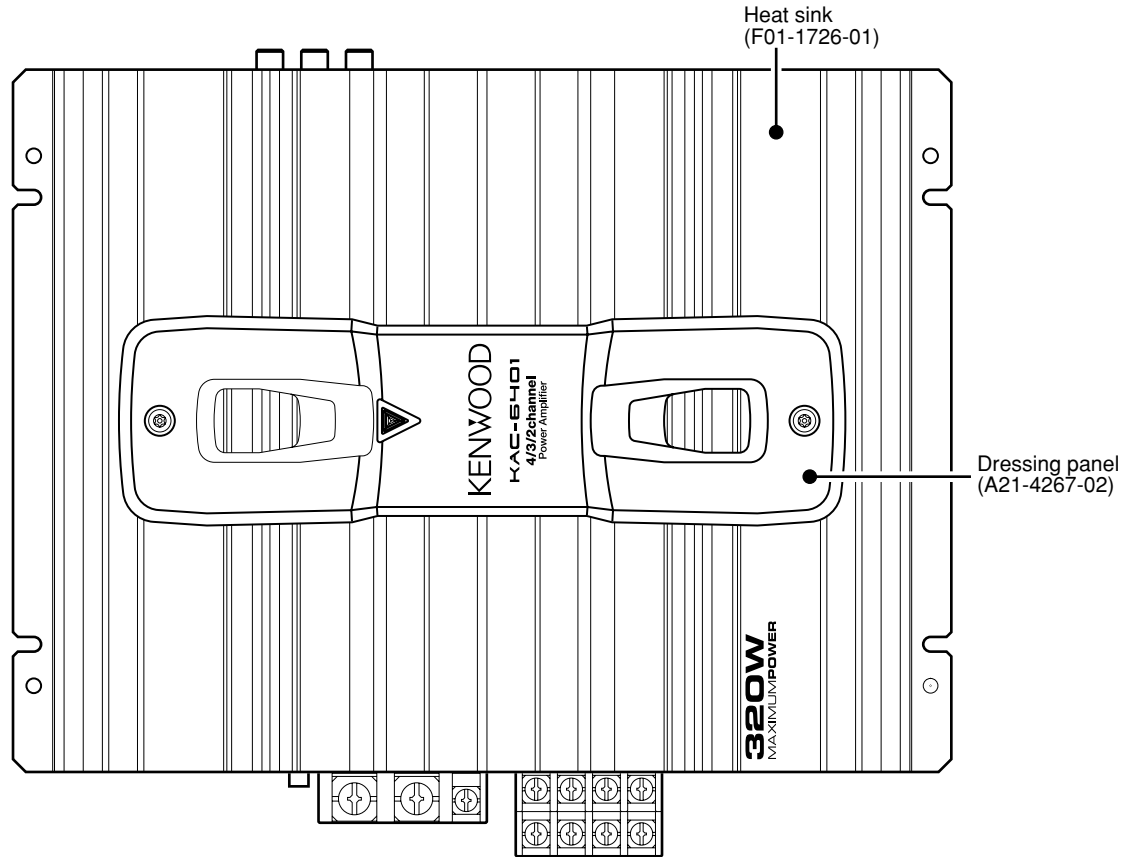

Fuse (F52-0014-05)

Connecting cord assy (E30-6144-05)

Accessory (W01-1606-05)

Screw set (N99-1587-05)

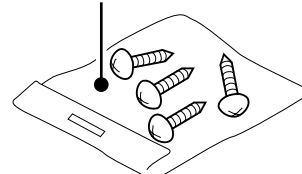
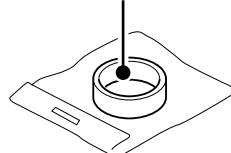
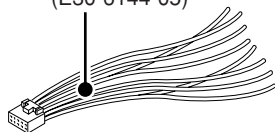

# KAC-6401

## ADJUSTMENT

No.	ITEM	INPUT SETTINGS	OUTPUT SETTINGS	RECEIVER SETTINGS	ALIGNMENT POINTS	ALIGN FOR	FIG.
Connect a cassette receiver or CD receiver.							
1	IDLE CURRENT	-	Connect a DC voltmeter across each resistor  R189 (A-Lch) R192 (A-Rch) R193 (B-Lch) R196 (B-Rch)	VOLUME : 0	(A) VR3 (L ch) VR4 (R ch)  (B) VR5 (L ch) VR6 (R ch)	2.5mV	(a)

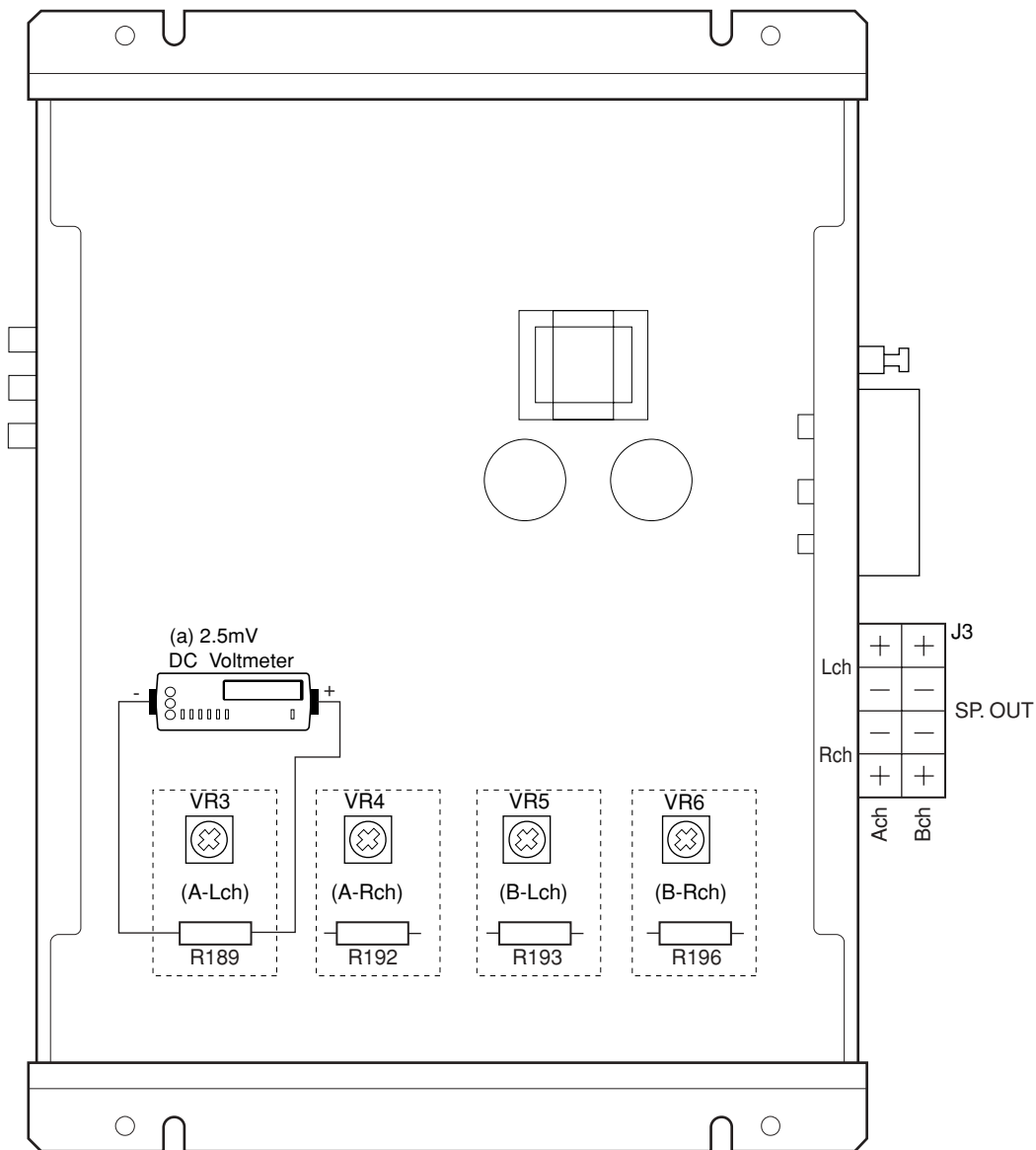

# PC BOARD (FOIL SIDE VIEW)

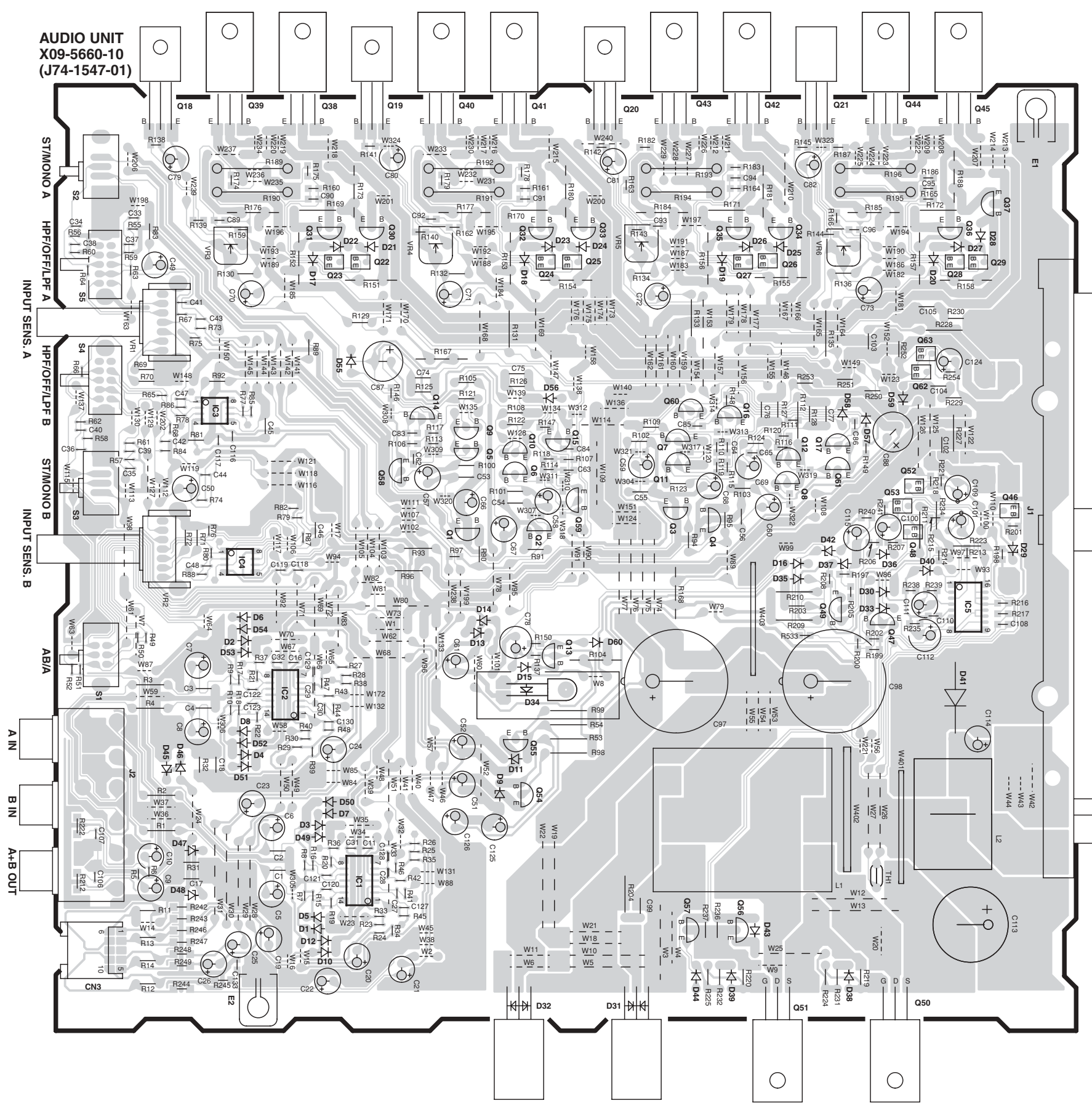

X09-5660-10

IC	Q	Address	IC	Q	Address
1		6C		30	2C
2		5C		31	2C
3		3C		32	2D
4		4C		33	2E
5		4G		34	2F
	1	4D		35	2E
	2	4D		36	2G
	3	4E		37	2G
	4	4E		38	2C
	5	4D		39	2C
	6	4D		40	2D
	7	4E		41	2D
	8	4F		42	2F
	9	4D		43	2E
	10	4D		44	2F
	11	4E		45	2G
	12	4F		46	4G
	13	5D		47	5F
	14	3D		48	4F
	15	4D		49	4F
	16	3E		50	7F
	17	4F		51	7F
	18	2B		52	4F
	19	2D		53	4F
	20	2E		54	5D
	21	2F		55	5D
	22	3C		56	6E
	23	3C		57	6E
	24	3D		58	4C
	25	3E		59	4E
	26	3F		60	3E
	27	3E		61	4F
	28	3G		62	3F
	29	3G		63	3F

Refer to the schematic diagram for the values of resistors and capacitors.

AUDIO UNIT (X09-5660-10)

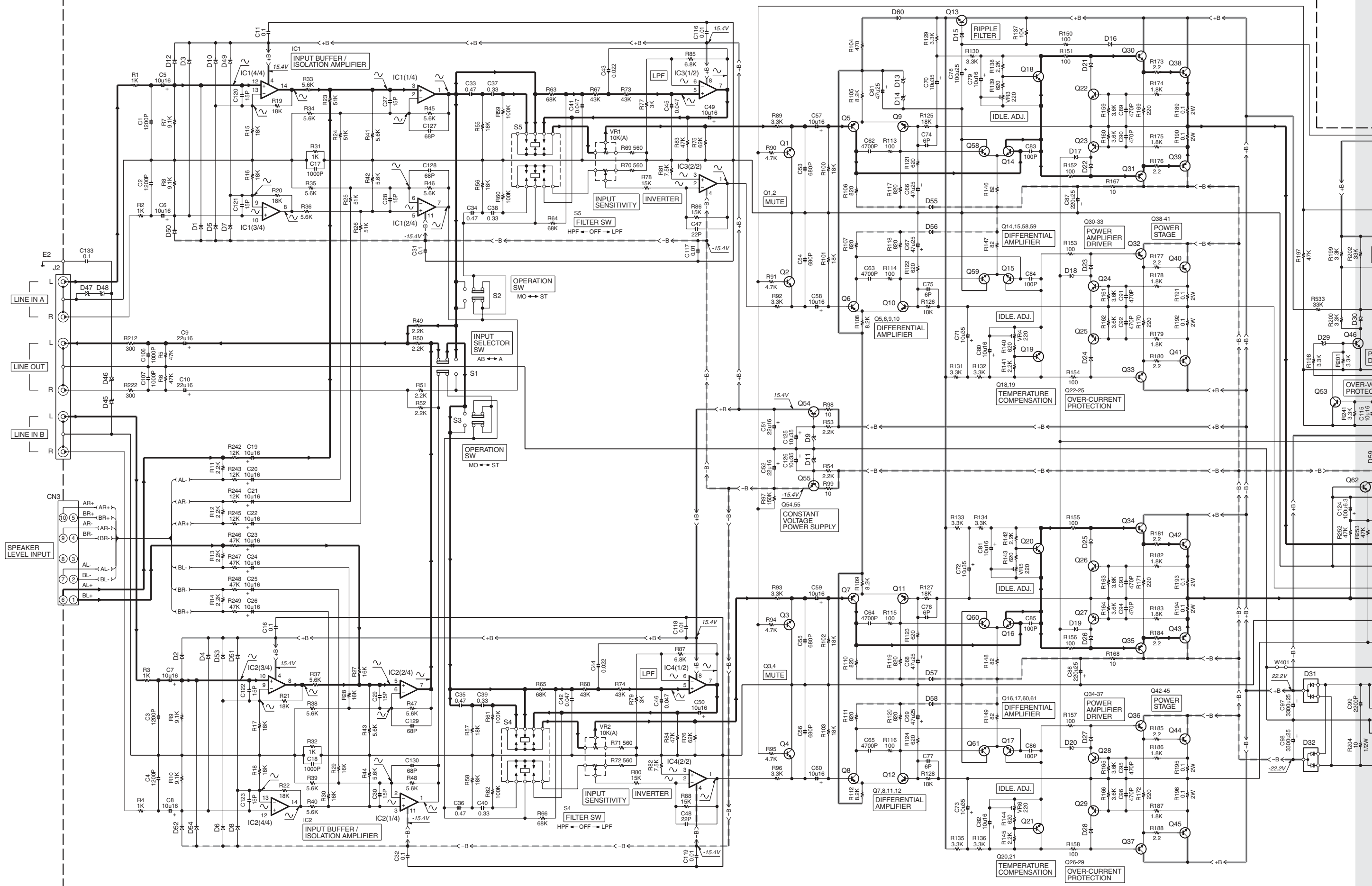

IC1,2 : NJM2060M  
 IC3,4 : NJM4565MD  
 IC5 : UPC494GS

Q1-4,13-17,58-61 : 2SC945(A)(Q,P)  
 Q5-12,49,56,57 : 2SA733(A)(Q,P)  
 Q18-21 : 2SC4137(V,W)  
 Q22,25,26,29,46,48,52,53 : 2SC2412K  
 Q23,24,27,28,62,63 : 2SA1037K  
 Q30,33,34,37,54 : 2SC1627A  
 Q31,32,35,36,47,55 : 2SA817A  
 Q38,41,42,45 : 2SC4511\*B  
 Q39,40,43,44 : 2SA1725\*B  
 Q50,51 : FKV550T\*B

D1-8,10,12,15-28,30,33,35,36,38-40,43,44,49-60 : 1SS133  
 D9,11,42 : RD16J(S)(B)  
 D13,14 : RD8.2J(S)(B)  
 D29 : RD7.5J(S)(B)  
 D31 : FMU22S\*A  
 D32 : FMU22R\*A  
 D34 : B30-1460-05  
 D37 : RD10J(S)(B)  
 D41 : 1N5406-M  
 D45-48 : RD5.1J(S)(B)

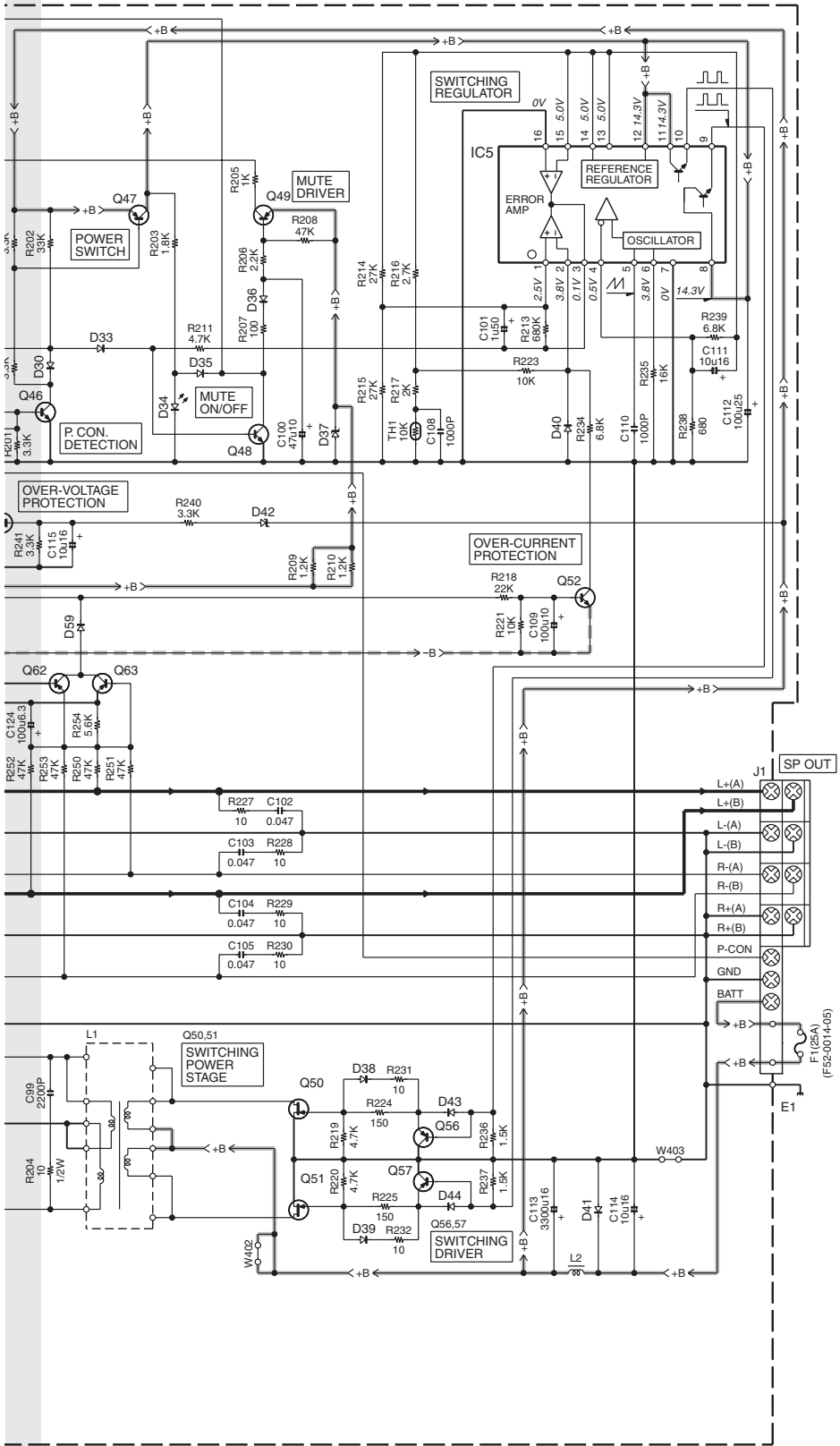
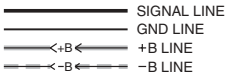

2SA733(A)  
 2SA817A  
 2SC1627A  
 2SC945(A)

2SA1037K

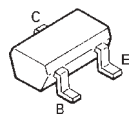

NJM4565MD

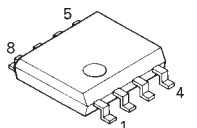

2SC2412K



UPC494GS

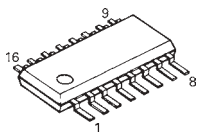

2SC4137

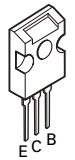

NJM2060M

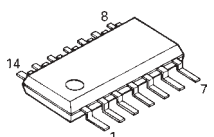

2SA1725JB  
 2SC4511JB

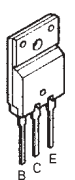

**CAUTION :** For continued safety, replace safety critical components only with manufacturer's recommended parts (refer to parts list).  
 ⚠ Indicates safety critical components. To reduce the risk of electric shock, leakage-current or resistance measurements shall be carried out (exposed parts are acceptably insulated from the supply circuit) before the appliance is returned to the customer.

• DC voltages are as measured with a high impedance voltmeter. Values may vary slightly due to variations between individual instruments or/and units.

# KAC-6401

## EXPLODED VIEW (UNIT)

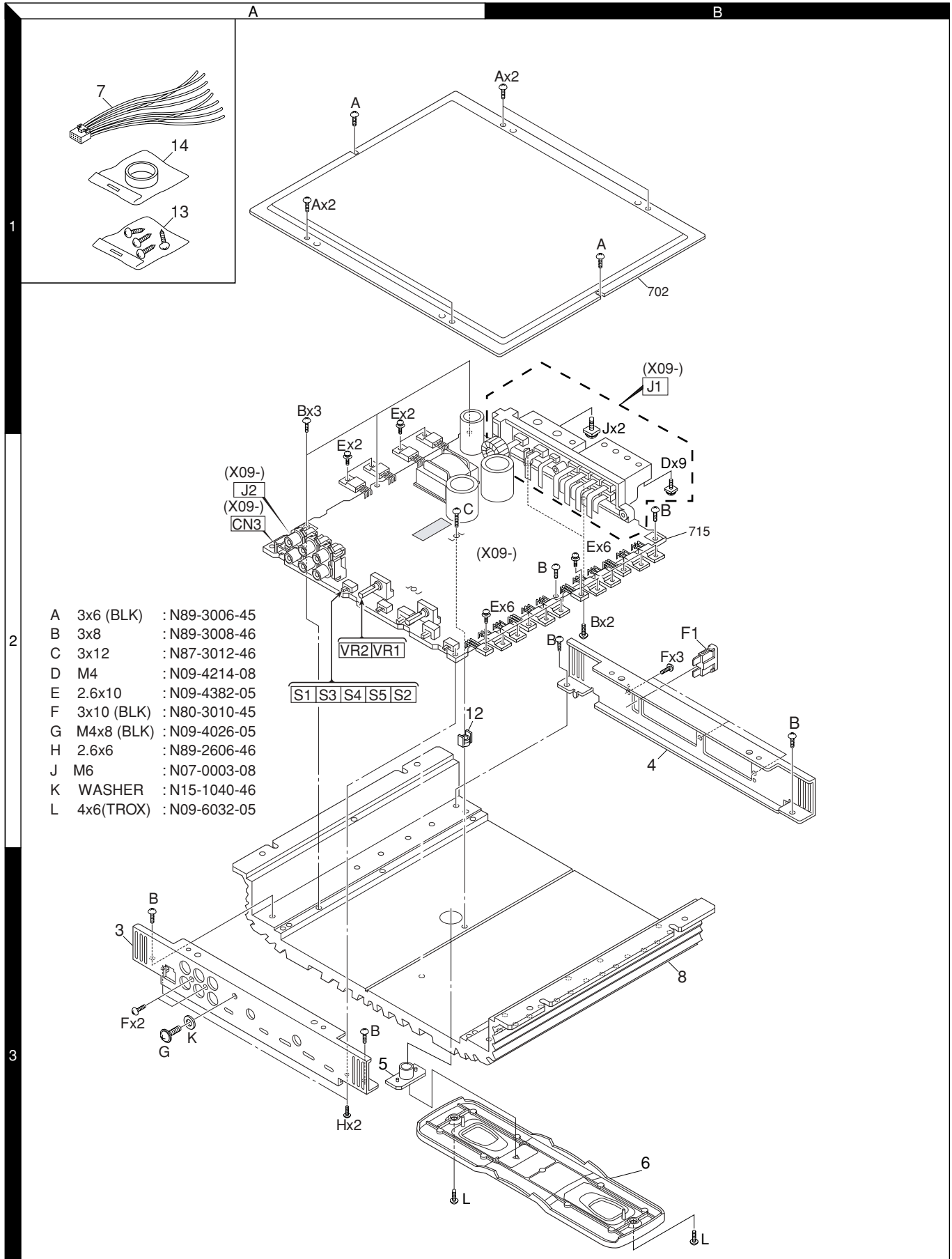

## PARTS LIST

\* New parts

Parts without **Parts No.** are not supplied.

Les articles non mentionnés dans le **Parts No.** ne sont pas fournis.

Teile ohne **Parts No.** werden nicht geliefert.

Ref. No.	Add	New	Parts No.	Description	Destination	Ref. No.	Add	New	Parts No.	Description	Destination
<b>KAC-6401</b>											
3	3A		A64-3050-02	PANEL		C51,52			CE04DW1C220M	ELECTRO 22UF 16WV	
4	2B		A84-0345-02	REAR PANEL		C53-56			CK45FB1H681K	CERAMIC 680PF K	
5	3A		B19-2213-04	LIGHTING BOARD		C57-60			CE04DW1C100M	ELECTRO 10UF 16WV	
6	3A		A21-4267-02	DRESSING PANEL		C61			CE04DW1E470M	ELECTRO 47UF 25WV	
-			B46-0100-50	WARRANTY CARD		C62-65			CK73GB1H472K	CHIP C 4700PF K	
-			B64-2564-00	INST.MANUAL (ENG)	KE	C66-69			CE04DW1E470M	ELECTRO 47UF 25WV	
-			B64-2565-00	INST.MANUAL (FRE,SPA)	KE	C70-73			CE04DW1V100M	ELECTRO 10UF 35WV	
-			B64-2566-00	INST.MANUAL (GER,DUT)	E	C74-77			CC45FSL1H060D	CERAMIC 6.0PF D	
-			B64-2567-00	INST.MANUAL (ITA,POR)	E	C78			CE04DW1E101M	ELECTRO 100UF 25WV	
-			B64-2568-00	INST.MANUAL (ENG,T-CHI)	M	C79-82			CE04DW1C100M	ELECTRO 10UF 16WV	
7	1A		E30-6144-05	CONNECTING CORD ASS'Y		C83-86			CC73GCH1H101J	CHIP C 100PF J	
8	3B		F01-1726-01	HEAT SINK		C87,88			CE04DW1E221M	ELECTRO 220UF 25WV	
△ F1	2B		F52-0014-05	FUSE(BLADE TYPE : 32V 25A)		C89-96			CC73GCH1H471J	CHIP C 470PF J	
-			H10-4864-03	POLYSTYRENE FOAMED FIXTURE		C97,98			C90-5376-05	ELECTRO 3300UF 25WV	
-			H25-0321-04	PROTECTION BAG (600X315X0.03)		C99			CF92FV1H222J	MF-C 2200PF J	
-			H25-0336-04	PROTECTION BAG (170X250X0.03)		C100			CE04DW1A470M	ELECTRO 47UF 10WV	
-			H54-2835-03	ITEM CARTON CASE	ET	C101			CE04DW1H010M	ELECTRO 1.0UF 50WV	
-			H54-2872-03	ITEM CARTON CASE	M	C102-105			CF92FV1H473J	MF-C 0.047UF J	
12	2A		J30-1066-14	SPACER		C106-108			CK73GB1H102K	CHIP C 1000PF K	
13	1A		N99-1587-05	SCREW SET		C109			CE04DW1A101M	ELECTRO 100UF 10WV	
A	1A		N89-3006-45	BINDING HEAD TAPTITE SCREW		C110			CK73GB1H102K	CHIP C 1000PF K	
B	1A		N89-3008-46	BINDING HEAD TAPTITE SCREW		C111			CE04DW1C100M	ELECTRO 10UF 16WV	
C	2A		N87-3012-46	BRAZIER HEAD TAPTITE SCREW		C112			CE04DW1E101M	ELECTRO 100UF 25WV	
D	2B		N09-4214-08	SCREW		C113			C90-2689-05	ELECTRO 3300UF 16WV	
E	2B		N09-4382-05	TAPTITE SCREW		C114			CE04HW1C100M	NP-ELEC 10UF 16WV	
F	2B		N80-3010-45	PAN HEAD TAPTITE SCREW		C115			CE04DW1C100M	ELECTRO 10UF 16WV	
G	3A		N09-4026-05	TAPPING SCREW		C116-119			CK73GB1H103K	CHIP C 0.010UF K	
H	3A		N89-2606-46	BINDING HEAD TAPTITE SCREW		C120-123			CC73GCH1H150J	CHIP C 15PF J	
J	2B		N07-0003-08	SCREW		C124			CE04DW0J101M	ELECTRO 100UF 6.3WV	
K	2A		N15-1040-46	FLAT WASHER		C125,126			CE04DW1V100M	ELECTRO 10UF 35WV	
L	3A		N09-6032-05	DRESSED SCREW		C127-130			CC73GCH1H680J	CHIP C 68PF J	
14	1A		W01-1606-05	ACCESSORY		C133			CK73GB1C104K	CHIP C 0.10UF K	
<b>AUDIO UNIT (X09-5660-10)</b>											
C1-4			CF92FV1H122J	MF-C 1200PF J		△ CN3			E58-0919-05	RECTANGULAR RECEPTACLE	
C5-8			CE04DW1C100M	ELECTRO 10UF 16WV		E1,2			E23-0149-05	TERMINAL	
C9,10			CE04DW1C220M	ELECTRO 22UF 16WV		J1			E70-0833-15	SCREW TERMINAL BOARD	
C11			CK73GB1C104K	CHIP C 0.10UF K		J2			E63-0874-05	PIN JACK	
C16			CK73GB1C104K	CHIP C 0.10UF K		TH1			ERT-D2ZHL103S	THERMISTOR	
C17,18			CF92FV1H102J	MF-C 1000PF J		W1-179			E31-0001-00	JUMPER WIRE	
C19-26			CE04DW1C100M	ELECTRO 10UF 16WV		W181-202			E31-0001-00	JUMPER WIRE	
C27-30			CC73GCH1H150J	CHIP C 15PF J		W206-240			E31-0001-00	JUMPER WIRE	
C31,32			CK73GB1C104K	CHIP C 0.10UF K		W401			E29-1859-05	LEAD PLATE	
C33-36			CK73GB1A474K	CHIP C 0.47UF K		W402			E29-1862-05	LEAD PLATE	
C37-40			CK73GB1A334K	CHIP C 0.33UF K		W403			E29-1859-05	LEAD PLATE	
C41,42			CK73GB1E473K	CHIP C 0.047UF K		L1			L19-0556-05	TRANSFORMER FOR CONVERTER	
C43,44			CK73GB1E223K	CHIP C 0.022UF K		L2			L33-1809-05	CHOKE COIL	
C45,46			CF92FV1H473J	MF-C 0.047UF J		F	2B		N80-3010-45	PAN HEAD TAPTITE SCREW	
C47,48			CC73GCH1H220J	CHIP C 22PF J		R1-4			RD14BB2C102J	RD 1.0K J 1/6W	
C49,50			CE04DW1C100M	ELECTRO 10UF 16WV		R5,6			RK73GB2A473J	CHIP R 47K J 1/10W	
						R7-10			RK73GB2A912J	CHIP R 9.1K J 1/10W	
						R11-14			RD14BB2C222J	RD 2.2K J 1/6W	
						R15-22			RK73GB2A183J	CHIP R 18K J 1/10W	
						R23-26			RK73GB2A513J	CHIP R 51K J 1/10W	

E : Europe K : North America M : Other Areas

△ Indicates safety critical components.

# KAC-6401

## PARTS LIST

\* New parts

Parts without **Parts No.** are not supplied.

Les articles non mentionnés dans le **Parts No.** ne sont pas fournis.

Teile ohne **Parts No.** werden nicht geliefert.

### AUDIO UNIT (X09-5660-10)

Ref. No.	A d d	N e w	Parts No.	Description	Desti- nation
R27-30			RK73GB2A163J	CHIP R 16K J 1/10W	
R31,32			RD14BB2C102J	RD 1.0K J 1/6W	
R33-48			RK73GH1J562D	CHIP R 5.6K D 1/16W	
R49-52			RK73GB2A222J	CHIP R 2.2K J 1/10W	
R53,54			RD14BB2C222J	RD 2.2K J 1/6W	
R55-58			RK73GB2A183J	CHIP R 18K J 1/10W	
R59-62			RK73GB2A104J	CHIP R 100K J 1/10W	
R63-66			RK73GB2A683J	CHIP R 68K J 1/10W	
R67,68			RK73GB2A433J	CHIP R 43K J 1/10W	
R69-72			RD14BB2C561J	RD 560 J 1/6W	
R73,74			RK73GB2A433J	CHIP R 43K J 1/10W	
R75,76			RK73GB2A623J	CHIP R 62K J 1/10W	
R77			RK73GB2A302J	CHIP R 3.0K J 1/10W	
R78			RK73GB2A153J	CHIP R 15K J 1/10W	
R79			RK73GB2A302J	CHIP R 3.0K J 1/10W	
R80			RK73GB2A153J	CHIP R 15K J 1/10W	
R81			RD14BB2C752J	RD 7.5K J 1/6W	
R82			RK73GB2A752J	CHIP R 7.5K J 1/10W	
R83			RD14BB2C473J	RD 47K J 1/6W	
R84			RK73GB2A473J	CHIP R 47K J 1/10W	
R85			RK73GB2A682J	CHIP R 6.8K J 1/10W	
R86			RK73GB2A153J	CHIP R 15K J 1/10W	
R87			RK73GB2A682J	CHIP R 6.8K J 1/10W	
R88			RK73GB2A153J	CHIP R 15K J 1/10W	
R89			RD14BB2C332J	RD 3.3K J 1/6W	
R90,91			RD14BB2C472J	RD 4.7K J 1/6W	
R92,93			RD14BB2C332J	RD 3.3K J 1/6W	
R94,95			RD14BB2C472J	RD 4.7K J 1/6W	
R96			RD14BB2C332J	RD 3.3K J 1/6W	
R97			RK73GB2A154J	CHIP R 150K J 1/10W	
R98,99			RD14BB2E100J	RD 10 J 1/4W	
R100-103			RD14BB2C183J	RD 18K J 1/6W	
R104			RD14NB2E471J	RD 470 J 1/4W	
R105			RD14BB2C822J	RD 8.2K J 1/6W	
R106,107			RK73GB2A821J	CHIP R 820 J 1/10W	
R108,109			RD14BB2C822J	RD 8.2K J 1/6W	
R110,111			RK73GB2A821J	CHIP R 820 J 1/10W	
R112			RD14BB2C822J	RD 8.2K J 1/6W	
R113-116			RK73GB2A101J	CHIP R 100 J 1/10W	
R117-120			RK73GB2A821J	CHIP R 820 J 1/10W	
R121-124			RD14BB2C621J	RD 620 J 1/6W	
R125-128			RD14BB2C183J	RD 18K J 1/6W	
R129-136			RD14BB2C332J	RD 3.3K J 1/6W	
R137			RK73GB2A103J	CHIP R 10K J 1/10W	
R138			RK73GB2A222J	CHIP R 2.2K J 1/10W	
R139,140			RK73GB2A621J	CHIP R 620 J 1/10W	
R141,142			RK73GB2A222J	CHIP R 2.2K J 1/10W	
R143,144			RK73GB2A621J	CHIP R 620 J 1/10W	
R145			RK73GB2A222J	CHIP R 2.2K J 1/10W	
R146-149			RK73GB2A820J	CHIP R 82 J 1/10W	
R150			RK73GB2A101J	CHIP R 100 J 1/10W	
R151-158			RD14NB2E101J	RD 100 J 1/4W	
R159-166			RK73GB2A362J	CHIP R 3.6K J 1/10W	
R167,168			RD14NB2E100J	RD 10 J 1/4W	
R169-172			RD14BB2E221J	RD 220 J 1/4W	

Ref. No.	A d d	N e w	Parts No.	Description	Desti- nation
R173			RD14NB2E2R2J	RD 2.2 J 1/4W	
R174,175			RK73GB2A182J	CHIP R 1.8K J 1/10W	
R176,177			RD14NB2E2R2J	RD 2.2 J 1/4W	
R178,179			RK73GB2A182J	CHIP R 1.8K J 1/10W	
R180,181			RD14NB2E2R2J	RD 2.2 J 1/4W	
R182,183			RK73GB2A182J	CHIP R 1.8K J 1/10W	
R184,185			RD14NB2E2R2J	RD 2.2 J 1/4W	
R186,187			RK73GB2A182J	CHIP R 1.8K J 1/10W	
R188			RD14NB2E2R2J	RD 2.2 J 1/4W	
R189-196			R92-2115-05	METAL FILM 0.1 J 2W	
R197			RK73GB2A473J	CHIP R 47K J 1/10W	
R198-201			RK73GB2A332J	CHIP R 3.3K J 1/10W	
R202			RK73GB2A333J	CHIP R 33K J 1/10W	
R203			RD14BB2C182J	RD 1.8K J 1/6W	
R204			RD14DB2H100J	SMALL-RD 10 J 1/2W	
R205			RK73GB2A102J	CHIP R 1.0K J 1/10W	
R206			RK73GB2A222J	CHIP R 2.2K J 1/10W	
R207			RK73GB2A101J	CHIP R 100 J 1/10W	
R208			RK73GB2A473J	CHIP R 47K J 1/10W	
R209,210			RD14BB2E122J	RD 1.2K J 1/4W	
R211			RD14BB2C472J	RD 4.7K J 1/6W	
R212			RK73EB2E301J	CHIP R 300 J 1/4W	
R213			RK73GB2A684J	CHIP R 680K J 1/10W	
R214,215			RK73GB2A273J	CHIP R 27K J 1/10W	
R216			RK73GB2A272J	CHIP R 2.7K J 1/10W	
R217			RK73GB2A202J	CHIP R 2.0K J 1/10W	
R218			RK73GB2A223J	CHIP R 22K J 1/10W	
R219,220			RD14BB2C472J	RD 4.7K J 1/6W	
R221			RK73GB2A103J	CHIP R 10K J 1/10W	
R222			RK73EB2E301J	CHIP R 300 J 1/4W	
R223			RD14BB2C103J	RD 10K J 1/6W	
R224,225			RD14BB2C151J	RD 150 J 1/6W	
R227,228			RD14BB2E100J	RD 10 J 1/4W	
R229-232			RD14BB2C100J	RD 10 J 1/6W	
R234			RD14BB2C682J	RD 6.8K J 1/6W	
R235			RK73GB2A163J	CHIP R 16K J 1/10W	
R236,237			RD14BB2C152J	RD 1.5K J 1/6W	
R238			RK73GB2A681J	CHIP R 680 J 1/10W	
R239			RK73GB2A682J	CHIP R 6.8K J 1/10W	
R240,241			RK73GB2A332J	CHIP R 3.3K J 1/10W	
R242-245			RK73EB2E123J	CHIP R 12K J 1/4W	
R246-249			RK73EB2E473J	CHIP R 47K J 1/4W	
R250-253			RD14BB2C473J	RD 47K J 1/6W	
R254			RK73GB2A562J	CHIP R 5.6K J 1/10W	
R533			RK73GB2A333J	CHIP R 33K J 1/10W	
VR1,2			R31-0232-05	VARIABLE RESISTOR 10K	
VR3-6			R32-0030-05	VARIABLE RESISTOR 220	
W304-314			R92-1252-05	CHIP R 0 OHM J 1/16W	
W317-324			R92-1252-05	CHIP R 0 OHM J 1/16W	
S1-3			S62-0842-05	SLIDE SWITCH	
S4,5			S31-2630-05	SLIDE SWITCH	
D1-8			1SS133	DIODE	
D9			RD16JS(B)	ZENER DIODE	
D10			1SS133	DIODE	

E : Europe K : North America M : Other Areas

△ Indicates safety critical components.



## PARTS LIST

\* New parts

Parts without **Parts No.** are not supplied.

Les articles non mentionnés dans le **Parts No.** ne sont pas fournis.

Teile ohne **Parts No.** werden nicht geliefert.

### AUDIO UNIT (X09-5660-10)

Ref. No.	A d d	N e w	Parts No.	Description	Desti- nation	Ref. No.	A d d	N e w	Parts No.	Description	Desti- nation
D11			RD16JS(B)	ZENER DIODE							
D12			1SS133	DIODE							
D13,14			RD8.2JS(B)	ZENER DIODE							
D15-28			1SS133	DIODE							
D29			RD7.5JS(B)	ZENER DIODE							
D30			1SS133	DIODE							
D31			FMU22S*A	DIODE							
D32			FMU22R*A	DIODE							
D33			1SS133	DIODE							
D34			B30-1460-05	LED							
D35,36			1SS133	DIODE							
D37			RD10JS(B)	ZENER DIODE							
D38-40			1SS133	DIODE							
D41			1N5406-M	DIODE							
D42			RD16JS(B)	ZENER DIODE							
D43,44			1SS133	DIODE							
D45-48			RD5.1JS(B)	ZENER DIODE							
D49-60			1SS133	DIODE							
IC1,2			NJM2060M	ANALOGUE IC							
IC3,4			NJM4565MD	IC (OP AMP X2)							
IC5			UPC494GS	ANALOGUE IC							
Q1-4			2SC945(A)(Q,P)	TRANSISTOR							
Q5-12			2SA733(A)(Q,P)	TRANSISTOR							
Q13-17			2SC945(A)(Q,P)	TRANSISTOR							
Q18-21			2SC4137(V,W)	TRANSISTOR							
Q22			2SC2412K	TRANSISTOR							
Q23,24			2SA1037K	TRANSISTOR							
Q25,26			2SC2412K	TRANSISTOR							
Q27,28			2SA1037K	TRANSISTOR							
Q29			2SC2412K	TRANSISTOR							
Q30			2SC1627A	TRANSISTOR							
Q31,32			2SA817A	TRANSISTOR							
Q33,34			2SC1627A	TRANSISTOR							
Q35,36			2SA817A	TRANSISTOR							
Q37			2SC1627A	TRANSISTOR							
Q38			2SC4511*B	TRANSISTOR							
Q39,40			2SA1725*B	TRANSISTOR							
Q41,42			2SC4511*B	TRANSISTOR							
Q43,44			2SA1725*B	TRANSISTOR							
Q45			2SC4511*B	TRANSISTOR							
Q46			2SC2412K	TRANSISTOR							
Q47			2SA817A	TRANSISTOR							
Q48			2SC2412K	TRANSISTOR							
Q49			2SA733(A)(Q,P)	TRANSISTOR							
Q50,51			FKV550T*B	FET							
Q52,53			2SC2412K	TRANSISTOR							
Q54			2SC1627A	TRANSISTOR							
Q55			2SA817A	TRANSISTOR							
Q56,57			2SA733(A)(Q,P)	TRANSISTOR							
Q58-61			2SC945(A)(Q,P)	TRANSISTOR							
Q62,63			2SA1037K	TRANSISTOR							

E : Europe K : North America M : Other Areas

△ Indicates safety critical components.

# KAC-6401

## SPECIFICATIONS

### Audio Section

Rated Power Output (4Ω 20Hz~20kHz : A, B-ch) .....	30W x 4 (0.08% THD)
(4Ω DIN45324, +B=14.4V : A, B-ch) .....	30W x 4
(2Ω 1kHz : A, B-ch) .....	40W x 4 (0.8% THD)
Bridged Power Output (4Ω 1kHz) .....	80W x 2 (0.8% THD)
Max Power Output .....	160W x 2
Low-Pass Filter (A, B-ch) .....	80Hz (12dB/oct.)
High-Pass Filter (A, B-ch) .....	150Hz (12dB/oct.)
Frequency Response (0, -3dB) .....	5Hz~50kHz
Signal to Noise Ratio .....	100dB
Sensitivity (Max.) .....	0.2V (Rated Output)
Sensitivity (Min.) .....	5.0V (Rated Output)
Input Impedance .....	10kΩ

### General

Operating Voltage .....	14.4V (11V~16V allowable)
Current consumption (1kHz 10% THD) .....	18A
Installation Size (W x H x D) .....	268 x 59 x 220 mm (10-9/16 x 2-1/4 x 8-11/16 inch)
Weight .....	2.9kg

---

KENWOOD follows a policy of continuous advancements in development. For this reason specifications may be changed without notice.

---

## KENWOOD CORPORATION

2967-3, Ishikawa-machi, Hachioji-shi, Tokyo 192-8525, Japan

### KENWOOD USA CORPORATION

P.O. BOX 22745, 2201 East Dominguez Street, Long Beach, CA90801-5745, U.S.A.

### KENWOOD ELECTRONICS CANADA INC.

6070 Kestrel Road, Mississauga, Ontario, Canada L5T 1S8

### KENWOOD ELECTRONICS LATIN AMERICA S.A.

P.O. Box 55-2791 Paifilla, Plaza Credicorp Bank Panama,  
Piso 9, Oficina 901, Calle 50, Panama, Rep. de Panama

### KENWOOD ELECTRONICS BRASIL LTDA.

Alameda Ministro Rocha Azevedo No. 456,  
Edifício Jaú, 10o Andar, Cerqueira César, Cep 0140-001,  
São Paulo-SP-Brasil

### KENWOOD ELECTRONICS UK LIMITED

Kenwood House, Dwight Road, Watford, Herts, WD18 9EB, United Kingdom

### KENWOOD ELECTRONICS DEUTSCHLAND GMBH

Rembrücker-Str. 15, 63150 Heusenstamm, Germany

### KENWOOD ELECTRONICS FRANCE S.A.

13, Boulevard Ney, 75018 Paris, France

### KENWOOD ELECTRONICS BELGIUM N.V.

Leuvensesteenweg 248 J, 1800 Vilvoorde, Belgium

### KENWOOD ELECTRONICS ITALIA S.p.A.

Via G. Sirtori 7/9, 20129 Milano, Italy

### KENWOOD IBÉRICA S.A.

Bolivia, 239-08020 Barcelona, Spain

### KENWOOD ELECTRONICS AUSTRALIA PTY. LTD. (A.C.N. 001 499 074)

16 Giffnock Avenue, Centrecourt Estate, North Ryde,  
N.S.W. 2113, Australia

### KENWOOD ELECTRONICS (HONG KONG) LTD.

Unit 3712-3724, Level 37, Tower 1, Metroplaza, 223 Hing Fong Road, Kwai Fong, N.T.,  
Hong Kong

### KENWOOD ELECTRONICS GULF FZE

P.O. Box 61318, Jebel Ali, Dubai, U.A.E.

### KENWOOD ELECTRONICS (THAILAND) CO., LTD.

2019 New Pechburi Road, Bangkok, Huaykwang, Bangkok, 10320 Thailand

### KENWOOD ELECTRONICS SINGAPORE PTE. LTD.

1 Genting Lane, #07-00, Kenwood Building, Singapore, 349544

### KENWOOD ELECTRONICS (MALAYSIA) SDN BHD

#4.01 Level 4, Wisma Academy Lot 4A, Jalan 19/1, 46300 Petaling Jaya, Selangor Darul Ehsan,  
Malaysia